



services@hayeshomeworks.com
770-498-4663

Friday, January 24th, 2009 (Estimate Review)

Dear Mr. and Mrs. _____,

Thank you for giving us the opportunity to earn your confidence.

We are ready to review with you, your initial cost and schedule estimates.

If you have any questions or concerns after our meeting today, please contact us.

Sincerely,

Thomas Hayes

770-498-4663

thomas@hayeshomeworks.com

Project: _____

Page 1



Friday, January 24th, 2009 (Estimate Review)

1. Scope
 - a. Design
 - i. Front Entry Railing
 - ii. Built-in Wine Rack
 - iii. Landscape Lighting
2. Cost Estimate
 - a. By Category
 - b. By Area of Interest
3. Schedule Estimate
4. Payment Procedure
 - a. % Deposit, processing, types accepted
 - b. Remainder at job satisfaction



Friday, January 24th, 2009 (Estimate Review)

5. Finish Allowances
6. Site Access
 - a. Hours, days of wk
 - i. weekend access
7. Start Date or Follow-up



services@hayeshomeworks.com
770-498-4663

Friday, January 24th, 2009 (Estimate Review)

ALLOWANCES

Bar Faucet	\$362
Recessed Lighting	\$77



Friday, January 24th, 2009 (Estimate Review)

Costs by Category







Groups	Tasks / Job Description	Materials Description	Costs
INTERIOR WALLS			
	3 drywall repairs in basement ceiling		
	Interior Walls Group Sub Total		XXX
PLUMBING			
	Mbath Vanity Faucet Leak	Delta	
	Mbath Jacuzzi Faucet Leak	new cartridges from Jacuzzi	
	Basement Bar Sink/Drain/Faucet	faucet allowance	
		weathered copper drain	
	Plumbing Group Sub Total		XXX
ELECTRICAL - INTERIOR			
	2x recessed lighting	Trim Packages for 4" lights	
		bulbs	
	Electrical Group Sub Total		XXX
CARPENTRY - INTERIOR			
	Cabinet Doors in Basement Bar	4 Base Cabinet doors , match wood, stain, trim	



	Custom Built-In wine rack	To Spec/Drawing, ~48 x 30" x 91"	
	Basement Bar Faucet Holes	drilling holes in granite	
	Carpentry-Interior Group Sub Total		XXX
	VARIOUS EXTERIOR		
	Iron Railing - Front Entry	2x 8' w/ radius end (custom)	
	Step System	Repair Existing	
	Picture Window Replace	59" x 72" double pane/interior grill unit	
	Front Yard Landscape Lighting Repair	Timer	
	Back Yard Landscape Lighting	Lights	
	Materials	High Watts Timer	
	Materials	Cable	
	Waterfall Pump Replace (Drain/Clean/Replace)	Pump	
	Gutter Repair	Rivets and Gutter Drain Pipe	
	Varioius Exterior Group Sub Total		XXXX
		Grand Total	XX,XXX

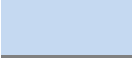

Sorted by Area of Interest

	\$XXX	Leaky Faucets Repair
	\$X,XXX	Basement (Bar, Built-in Wine Rack, drywall repair, recessed lighting)
	\$X,XXX	Front Entry (Railing, Steps Repair)
	\$XXX	Picture Window
	\$X,XXX	Exterior Lighting (front, rear)
	\$XXX	Exterior Water (waterfall, downspouts)

Friday, January 24th, 2009 (Estimate Review)

Built-in Wine Rack (Concept)

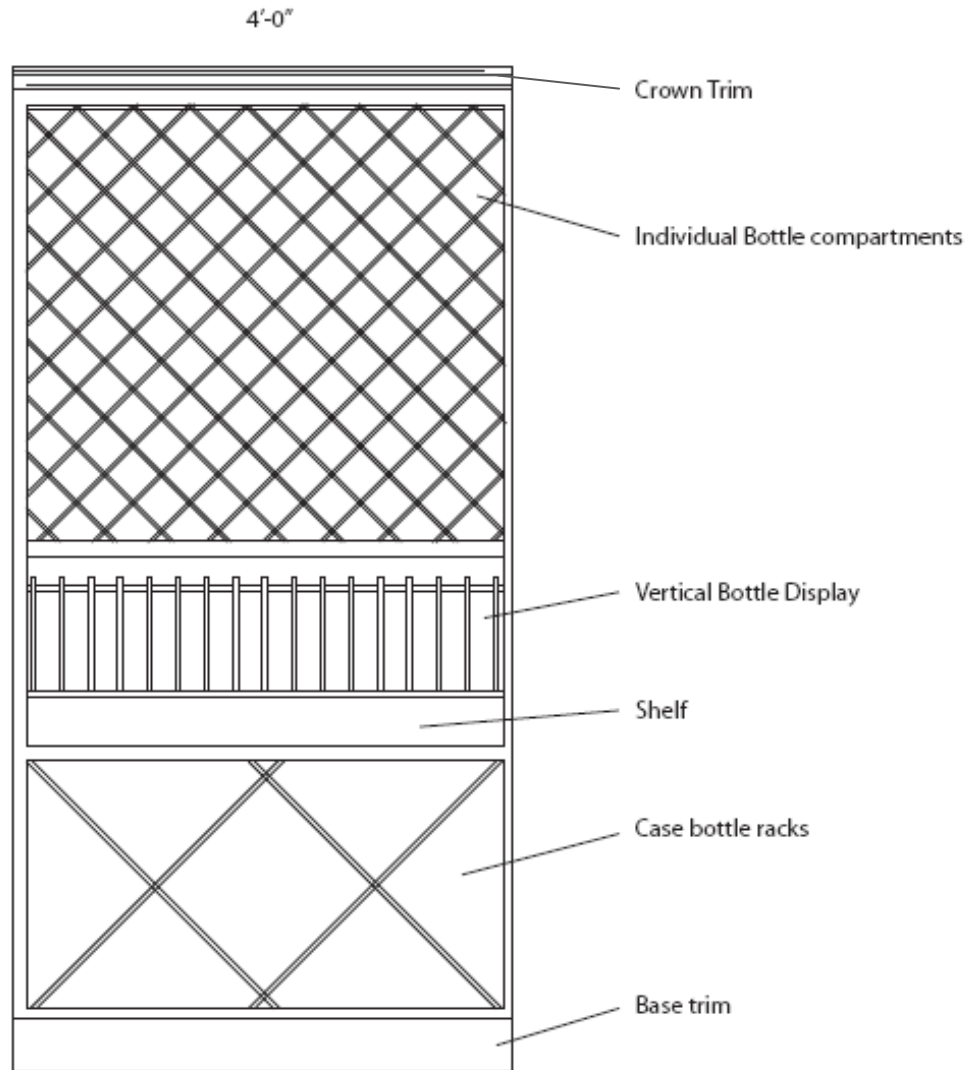

ELEVATION WINE RACK/DISPLAY

Friday, January 24th, 2009 (Estimate Review)

Landscape Lighting (Concept)

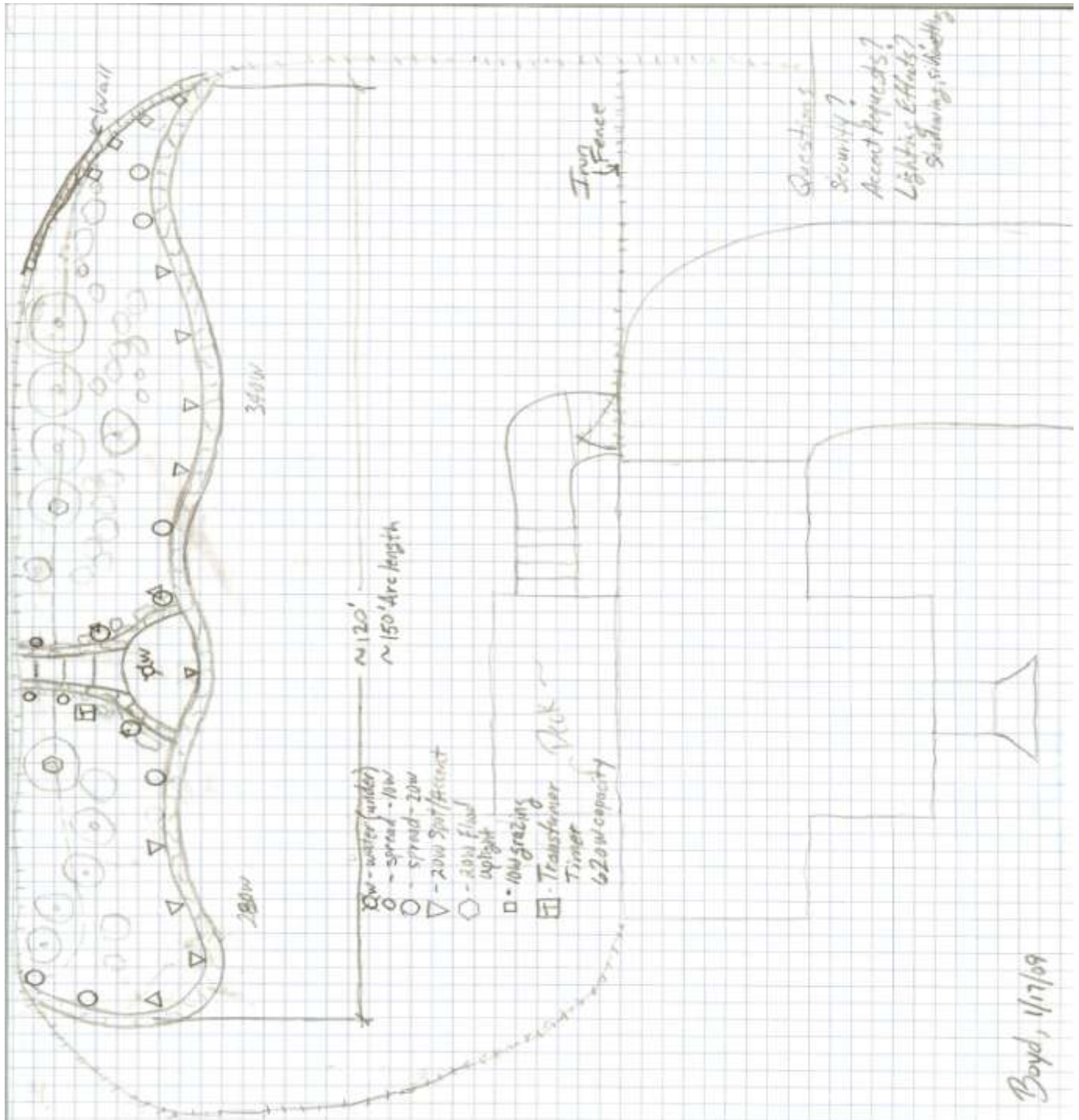



Friday, January 24th, 2009 (Estimate Review)

Front Entry Railing (Concept)

$\frac{3}{4}$ x $\frac{3}{4}$ pickets with alternating collars. This will have a regular dixie cap rail. Rail will be attached to the house.

To be primed and painted black.

**concept drawing to be approved prior to start*